

Perform Series, Lateral Raise

This lateral raise machine is built for controlled shoulder work, giving users a smooth and stable way to target the deltoids with confidence. It delivers consistent resistance through the full range of motion and uses a compact, commercial grade design that fits comfortably into strength zones of any size.

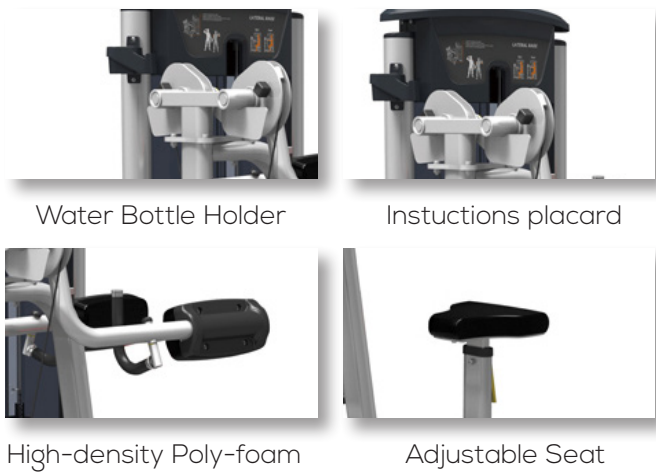

Technical Specifications

Rating	Commercial
Adjustments	Adjustable seat for user comfort and to allow easy operation
Upholstery	High-density poly-foam and double stitches offer comfort and durability
Tubing	Tube of the functional part is primarily at a 3mm thickness.
Instructions Plaque	Instructions placards to review proper set-up, movement and muscles trained
Shroud	Translucent ABS shroud at a thickness of 3.2mm ensures ultra-durability and shock resistance.
Weight Stack	91kg 200lbs
Product Weight	175.5kg
Maximum User Weight	150kg 330lbs
Dimensions	L 122.2 x W 121.3 x H 150.6 cm

Key Features

Space efficient design requires minimal floor space	•
Self-lubricate American loos™ cable with nylon-coated 12 complex fiber ensures service life more than 250 thousand times.	•
Water bottle holder fixed on the cage is within reach.	•
Ergonomic handlebars in TPV material with aluminium ring limit offers comfort and security during a workout	•
All dynamic components are shielded for safety purpose	•
Lathed pulley with bearings of less tolerance ensure smooth movement	•
Meets EN957 safety regulation	•